



HJX 型桁架式吸泥机 TYPE-HJX SEDIMENT SUCKER BY TRUSS

<http://www.jdpyhj.com>

用途 Applications

主要用于给排水工程中平流沉淀池的排泥，吸泥方式根据用户的要求，有虹吸式和泵吸式、泵虹两吸式等三种可供选择。虹吸式采用潜水泵配水射器或真空泵来形成虹吸，利用沉淀池与排泥槽内的液位差排泥，泵吸式直接采用潜污泵抽取沉淀污泥。

The Sucker is mainly used in water supply and sewage engineering to discharge sediment in horizontal sedimentation tanks. Sediment may be absorbed by siphonage or pump or using the two methods together. The vacuum is formed by vacuum pump or formed by water jet in diving pump, and sediment is discharged by siphonage due to the difference between the water levels in the tank and in the sediment-discharge trough. Diving pumps are directly used to discharge sediment.

特点 Features

1. 传动装置采用轴装式减速机或法兰直联型减速机,外形精巧,拆装方便。
 2. 驱动车轮带有自动纠偏功能,可确保吸泥机长距离运行无啃轨、爬轨现象。
 3. 吸泥系统可设反冲洗装置,以排除管路堵塞等意外。
 4. 泵吸式或泵虹两吸式采用无堵塞潜污泵,启动迅速,无需引水装置,操作维护简便。潜污泵与吸泥系统联接独特,不停池放水即可将潜污泵提出水面进行检修或更换。
 5. 可采用PLC控制,根据需要设置吸泥机的全程、半程运行方式。吸泥机的周期可采用时间控制,也可附泥位计检测池底积泥情况自动运行。
 6. 虹吸泥机吸泥管上可设独特的排泥量调节装置,可根据排泥浓度自动调整出泥量,节约用水。此技术订货时要特别注明。
1. The decelerator,transmission device of the Sucker,is connected by shaft or by flanges,has a perfect appearance and can be easily assembled or disassembled.
 2. There is a function for the driving wheel to rectify a deviation automatically,which keeps the sucker always running along the track without diverging ,even for a long distance.
 3. Device of back wash may be added to the system to prevent sediment from being blocked up in pipes.
 4. With non-blocking diving pump being used,the Suckers both by siphonage and by pump are quick to start, not in need of diversion device, and easy to operate and maintain .Due to the unique connection of the diving pump and the sucker,the pump can be checked or replaced with the whole system not stopping discharging water.
 5. The control of PLC can be adopted ,the sucker may be designed to work for a whole course, or for semi-course if necessary.The acion cycle of the sucker can be controlled by time,also can be automatically run on the condition that the sediment metering is adopted to determine volume of the sediment which is piled on the bottom of the tank..
 6. An unique dirt discharge adjustment device can be attached to the sucking pipe on siphoned machine to adjust dirt discharge quantity according to discharged dirt concentration.and save water.This technique is a patent of our company and please specify this requirement when ordering .

型号示例 Type and Its Indication

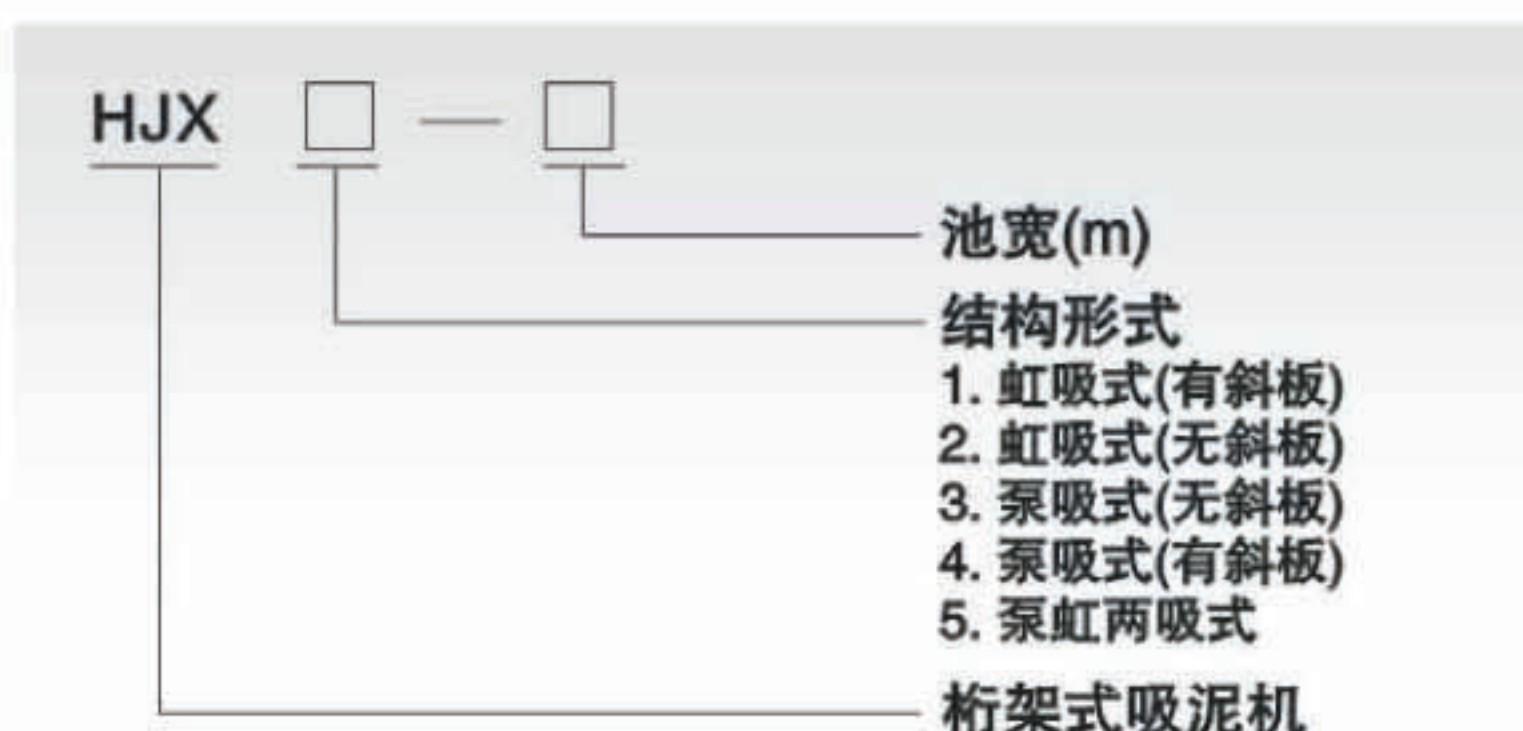

HJX₁ 外型结构 Shape

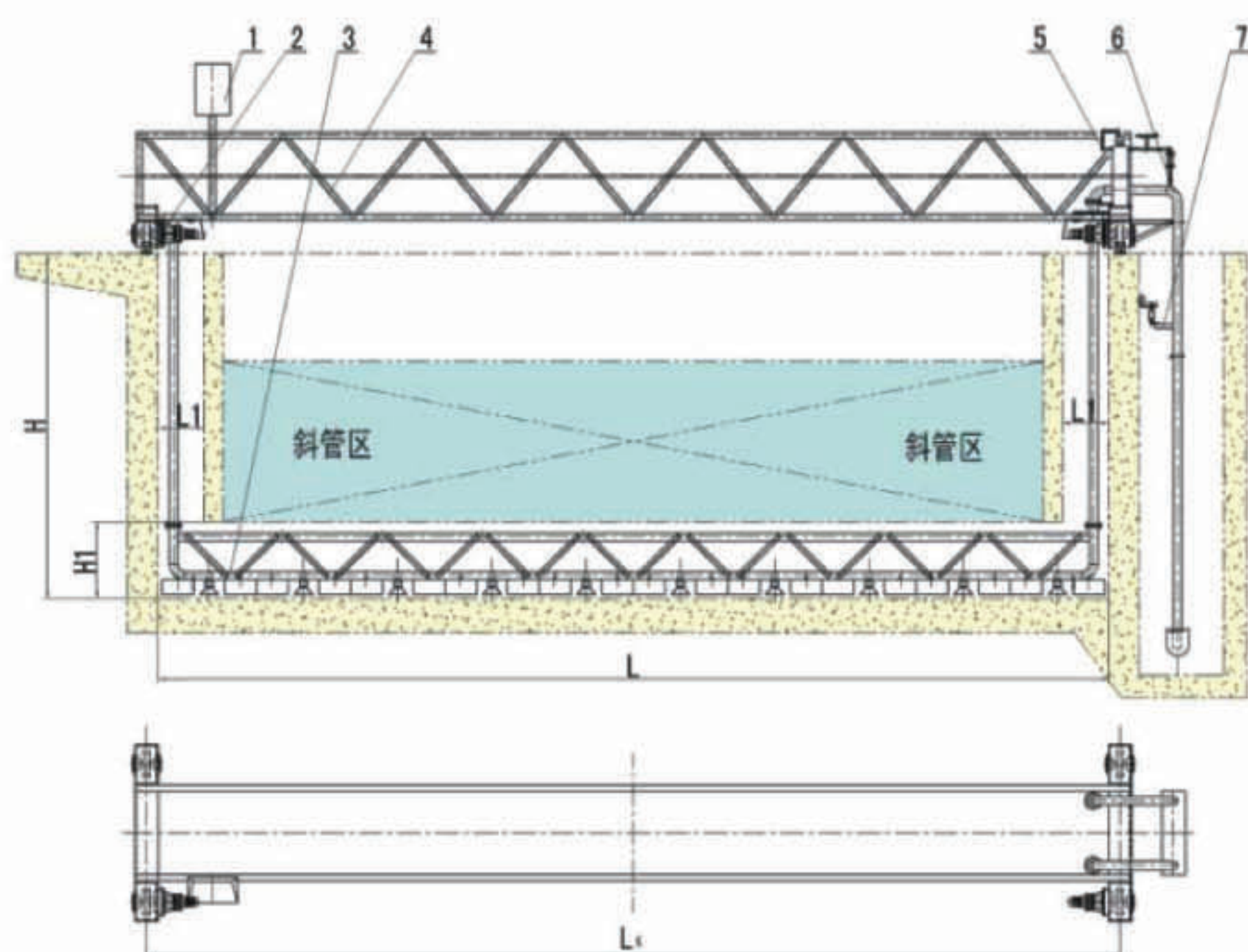

- 1、电控系统
- 2、传动装置
- 3、桁架
- 4、主梁
- 5、真空系统
- 6、管道系统
- 7、输电装置

HJX₄ 外型结构 Shape

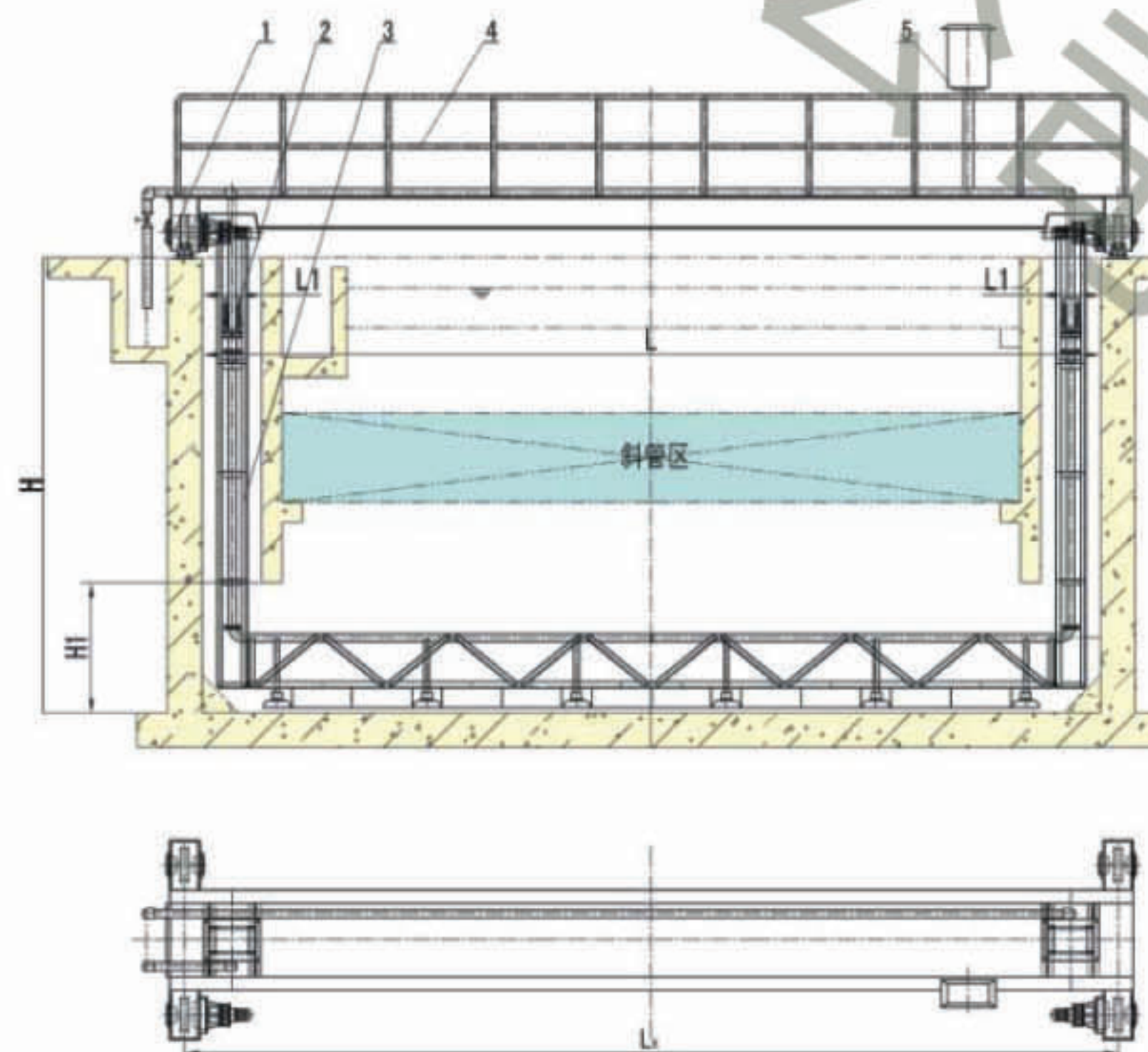

- 1、传动装置
- 2、吸泥系统
- 3、桁架
- 4、主梁
- 5、电控系统